

2
BED

Spacious Two Bedroom Semi-Detached Bungalow

21, Rose Walk Close, Newhaven, BN9 9NL



Price £295,000

Freehold

phillipmann
we do more

www.phillipmann.com

21 Rose Walk Close, BN9 9NL

Approximate Gross Internal Floor Area = 74.16 sq m / 798 sq ft

Garage Area = 9.38 sq m / 101 sq ft

Total Area = 83.54 sq m / 899 sq ft

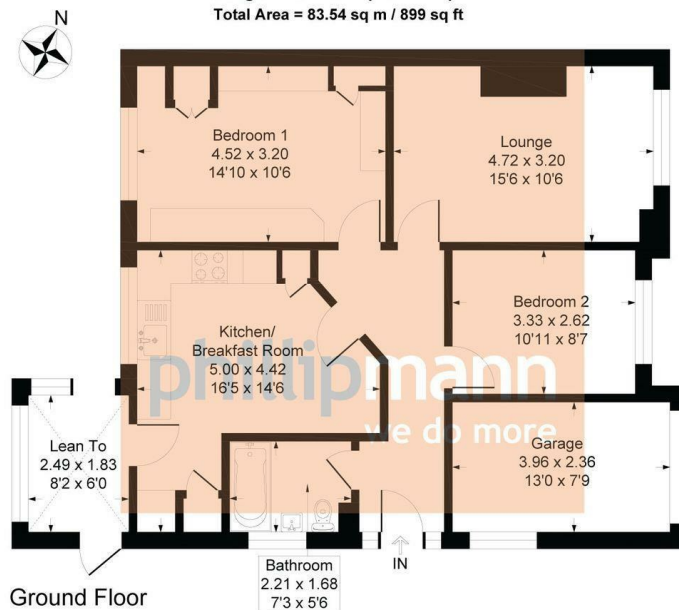

Illustration for identification purposes only, measurements are approximate, not to scale

inbrief...

Phillip Mann estate agents are delighted to offer for sale this spacious two bedroom semi-detached bungalow located in a popular close in Newhaven. The property is being sold with NO ONGOING CHAIN and offers scope for future development (STPP).

A part glazed entrance door gives access to entrance hall which has tiled flooring, loft access and doors which lead to the accommodation. The lounge is a lovely size room with a feature fireplace and a window overlooking the front. The kitchen/breakfast room is a generous size room which has a range of wall and base units incorporating a selection of cupboards and drawers. There is ample space for a appliances and a breakfast table. A window overlooks the rear garden and a door leads onto a rear porch.

Bedroom one is a lovely generous size double which has a range of bedroom furniture and overlooks the rear. Bedroom two is a further double and overlooks the front. Completing the inside is family bathroom which has a fitted bathroom suites comprising paneled bath, low level WC and wash hand basin.

Outside there is a generous size rear garden which is mainly laid to lawn.

To the front there is off road parking for several cars and access to a single garage.



Energy Rating C

Council Tax Band C

moreinfo...



Phillip Mann Newhaven Office
16 Bridge Street, Newhaven, BN9 9PJ
01273 517517

To see more details on this & all our homes go to
www.phillipmann.com